

Inoquest Labs Industries L.L.C.  
Building K-01  
Dubai Industrial City  
Dubai, UAE  
P.O. Box 49 00 99  
Phone 00971 4 450 8696  
Fax 00971 4 450 8697  
info@inoquestlabs.com  
www.inoquestlabs.com

BRINGS  
**BETTER HYGIENE**  
TO THE **CLEAN ZONES**



ISO 9001: 2015 certified



# 01

CSSD SUPPORT  
SYSTEMS

## Instrument Washing Station with cabinet - IWS 3S 200

- | Manufactured from 304G stainless steel.
- | Two instrument washing sinks and one slope sink for draining.
- | Deck mounted stretchable spring-loaded faucet.
- | Common swivel tap for washing sinks.
- | Air gun with spiral PU tube.
- | All worktop edges are raised to prevent water drips.
- | Water drain control for enzymatic soaking.
- | Perforated SS brush holder.
- | Horizontal bottom platform with door for storing chemicals / supplies.

dimension: 106"L x 30"W x 70"H.

Water gun with 8 different tips (Optional).



Water Gun



Slope Sink



raised Worktop Edge



Stretchable Spring Loaded Faucet

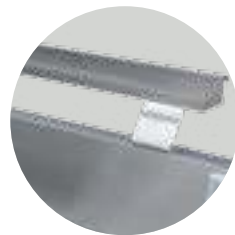

Perforated SS Brush Holder



Air Gun with Spiral PU Tube



Swivel Tap



Instrument Peg



Instrument Stringer



Instrument Cradle

## Instrument Washing Station -IWS 1S 200

- | For preliminary washing at the source and small facilities.
- | Manufactured from 304G stainless steel.
- | Integral sloped sink with spillway.
- | Deck mounted stretchable spring loaded faucet.
- | All worktop edges are raised to prevent water drips.
- | Drain control for enzymatic soaking.
- | Off the floor installation for easy floor cleaning.

dimension: 40"L x 24"W x 17"H.



IWS with Tray



raised Work Top Edge



## Instrument Drain Trolley

- | Manufactured from 304G stainless steel.
- | 4 wheels with 2 brakes.
- | removable perforated tray.
- | Plastic water collection bottle.
- | Custom design is available.

dimension: 24"L x 24"W x 36"H.

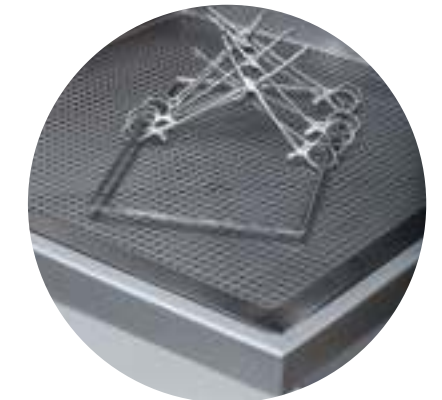

removable perforated tray with instrument stringer

## Pass Through Box – Static / Dynamic

- Manufactured from 304G stainless steel.
- Door with mechanical / electrical interlocking.
- Electromagnetic door interlocking with Buzzer and Indicator lamps.
- 6mm toughened glass for view panel.
- Optional UV lamp & Light.



Seamless curved edges as per HTM 64 standard



Interlocking electromagnet with switch



S.No	Model	description	Unit dimension L x W x H inches	Internal Work Area dimension L x W x H inches
1	PB 24E	Static Pass Box with electrical interlocking	24 x 24 x 24	16.25 x 21.5 x 17.75
2	PB 32E	Static Pass Box with electrical interlocking	32 X 24 X 32	24.25 X 21.5 X 25.75

## Linen Inspection & folding table

- Manufactured from 304G stainless steel.
- Illuminated transparent top surface.
- 3X, 7" magnifying glass with illumination.
- TENTE wheels with diagonal brakes.
- Custom designs are available.



S.No	Model	description	Unit dimension L x W x H inches	Illumination area L x W inches	Magnifier
1	LIT 100 2300	Linen Inspection Table- 32" wide without magnifier	90 X 32 X 42	40" x 28"	X
2	LIT 100 2301	Linen Inspection Table- 48" wide without magnifier	90 X 48 X 42	40" x 42"	X
3	LIT 100 2302	Linen Inspection Table- 60" wide without magnifier	90 X 60 X 42	40" x 54"	X
4	LIT 100MG 2300	Linen Inspection Table- 32" wide with magnifier	90 X 32 X 42	40" x 28"	√
5	LIT 100MG 2301	Linen Inspection Table- 48" wide with magnifier	90 X 48 X 42	40" x 42"	√
6	LIT 100MG 2302	Linen Inspection Table- 60" wide with magnifier	90 X 60 X 42	40" x 54"	√

## Packing Table

- Designed for pre - sterilization inspection and packing of instruments and equipments.
- Manufactured from 304G stainless steel.
- TENTE wheels with diagonal brakes.
- Flexible holding baskets and storage shelves.
- Inbuilt paper holding arms.
- Electrical / Data sockets.
- Lockable drawer - 1nos.
- 3X, 7" magnifying glass with illumination (Optional).
- Monitor / CPU / Laptop storage (Optional).
- Height adjustment (Optional).



S.No	Model	description	Unit dimension L x W x H inches	Overall height (H1) inches	Magnifier
1	PT 100M 1800	Packing Table -32" wide without magnifier	72 X 32 X 36	78	X
2	PT 100M 1801	Packing Table -39" wide with magnifier	72 X 39 X 36	78	√
3	PT 100M 2000	Packing Table -32" wide with magnifier	79 X 32 X 36	78	√
4	PT 100M 2001	Packing Table -39" wide with magnifier	79 X 39 X 36	78	√



## Basket Rack with baskets

- Manufactured from 304G stainless steel.
  - Suitable for transportation of sterilization baskets.
  - SS stopper for preventing basket fall during transportation.
  - TENTE wheels with diagonal brakes.
  - Available in SINGLE (4 baskets) / DOUBLE (8 baskets) column trolley.
- Dimension: 48"L x 17.5"B x 79"H (Double Column).  
24.75"L x 17.5"B x 79"H (Single Column).



Wire net Basket with / without silicon inserts



SPRI Baskets

Suitable for sterilization devices Easy stack / stock design

Basket Type 1 – 22.75" L x 15.5" W x 8"H.

Basket Type 2 - 22.75" L x 15.5" W x 4"H.



Sterile Storage Unit at the royal Care Super Speciality Hospital, Coimbatore - India.

## Sterile Cabinet

- | Manufactured from 304G stainless steel.
- | Lockable door.
- | Available with / without glass.
- | Adjustable horizontal shelves - 3 / 4 nos.

S.No	Model	description	Unit dimension L x W x H inches	Number of removable shelves
1	SDG 2D 100	Sterile storage - double door with glass	40 x 18 x 78	3
2	SDG 1D 100	Sterile storage - single door with glass	22 x 18 x 78	3
3	SDS 2D 100	Sterile storage - double door in SS	40 x 18 x 78	3
4	SDS 1D 100	Sterile storage - single door in SS	22 x 18 x 78	3
5	SPDG 2D 100	Sterile storage with platform & double door with glass	39 x 21.5 x 91.5	4
6	rSDS 3D 100	recessed sterile storage - double door in SS	84 x 18 x 70	4
7	rSDG 3D 100	recessed sterile storage - double door with glass	84 x 18 x 70	4



CSSD cladding with service door at SKS Hospital, Salem - India.

## Fixed Mesh Rack

- | Manufactured from 304G stainless steel.
  - | Solid or wire grid shelf option.
  - | Available with / without wheels.
  - | Adjustable horizontal shelves - 5 nos.
- dimension: 40"L x 20"W x 84"H.



## Closed Transportation Trolley

- | Manufactured from 304G stainless steel.
  - | Lockable door and double side pushing handle.
  - | Adjustable horizontal shelves - 3 nos.
  - | TENTE wheels with diagonal brakes.
  - | Visual indicator for Sterile / processed and Contaminated / Not Processed material (Optional).
  - | Flexible production in different designs and dimensions.
- dimension: 48"L x 24"W x 50"H.





# 02

CLEANING AND  
DISINFECTION  
SS EQUIPMENTS



### Surgical Scrub Sink - 200 series (Automatic)

- | Made of SS304G stainless steel with satin finish and most optimal RA value.
- | Automatic hands free / elbow operated water and automatic / foot operated hand scrub.
- | Curved joints as per HTM standards ensuring perfect hygiene and ease of cleaning.
- | Foldable back splash for easy refilling of hand scrub and routine maintenance.
- | The unit is wall mounted for easy cleaning of the floor.



### Single Station - SSAL 200PW

dimension: 33"L x 24.5"W x 31.25"H.



### Single Station - SSAK 400PW

dimension: 33"L x 29"W x 44"H.



### Double Station - DSAK 400PW

dimension: 63"L x 29"W x 44"H.

### Surgical Scrub Sink - 400 series

- | Top of the line scrub sink made of SS304G stainless steel with satin finish and most optimal RA value.
- | Automatic hands free / knee operated water and hand scrub.
- | Curved joints to avoid microbial deposition and growth, ensuring perfect hygiene and ease of cleaning.
- | Front knee panels are easily openable for refilling the hand scrub/ routine maintenance.
- | The unit is wall mounted for easy cleaning of the floor.



### Double Station - DSAL 200PW

dimension: 63"L x 24.5"B x 31.25"H.



### Three Station - TSAL 200PW

dimension: 93"L x 24.5"W x 31.25"H.

(Elbow operated)

### Surgical Scrub Sink - 200 series

- | Made of SS304G stainless steel with satin finish and most optimal RA value.
- | Elbow operated water and hand scrub dispenser.
- | Curved joints as per HTM standards ensuring perfect hygiene and ease of cleaning.
- | The unit is wall mounted for easy cleaning of the floor.



### Single Station - SSL 200

dimension: 33"L x 24.5"W x 29.25"H.



### Double Station - DSL 200

dimension: 63"L x 24.5"W x 29.25"H.



### Three Station - TSL 200

dimension: 93"L x 24.5"W x 29.25"H.

### Catheter Washing Sink

- | MOC : SS 304G.
- | Satin finish with the most optimal RA value.
- | Curved joints as per HTM standards ensuring perfect hygiene and ease of cleaning.
- | Provision for connecting the catheter using three way adapter.
- | Water / Air (7bar) connection through separate discharge pipe for easy use and safety.
- | The unit is wall mounted for easy cleaning of the floor.

dimension: 33"L x 24.5"W x 57.25"H.



### Plaster Sink

- | Suitable for hospitals and healthcare establishments where casting material preparation is done.
- | Made of SS304G stainless steel Satin finish.
- | Curved joints as per HTM standards ensuring perfect hygiene and ease of cleaning.
- | All worktop edges are raised to prevent water drips.
- | Plaster sump with lid to filter plaster debris.
- | The unit is wall mounted for easy cleaning of the floor.

dimension – 47.25"L x 24"W x 18"H.



### UV Water Filter

- | Compact UVC disinfection kit.
- | 200Litres per Hour.
- | Lamp active indication.
- | High germicidal power.40000 Micro ws/cm<sup>2</sup>



## Endoscope Washing Sink

- | Manufactured from 304G stainless steel.
- | Provided with INITIAL WASHING sink, ROUND IMMERSION sink with transparent lid and FINAL RINSING sink.
- | Air gun with coil PU tube accessible to the entire work surface.
- | All worktop edges are raised to prevent water drips.
- | Drain control for disinfectant soaking.
- | Platform for keeping the endoscope after rinsing.
- | Horizontal bottom platform for storage of chemicals / supplies.
- | Water gun with 8 different tips (Optional).



See Through Lid



Air Gun with Coil Tube



Swivel Tap



Water Gun

S.No	Model	description	Unitdimension L x W x H inches	Square Sink	round Sink	Air Gun with coil PU tube
1	EWS 1S 100	Endoscope Washing Sink with ONE sinks	33.5 x 29 x 42	√	X	√
2	EWS 2S 100	Endoscope Washing Sink with TWO sinks	85 x 29 x 42	√ (2)	X	√
3	EWS 2S 101	Endoscope Washing Sink with TWO sinks	65 x 29 x 42	√	√	√
4	EWS 3S 100	Endoscope Washing Sink with ThREe sinks	78 x 29 x 42	√	√ (2)	√

Square Sink dimension: 27.5" L x 19.5"B x 8" d.  
round Sink dimension: 19.5" dia x 10" d.

## Dialyzer Washing Sink

- | Fully stainless steel dialyzer washing sink.
- | The hospital pattern (HTM64) trough has fully radius internal corners for ease of cleaning and hygiene.
- | AMT DT01 tap with nozzles for various tube sizes.
- | Glass partition to prevent cross splashing.
- | 32mm stainless steel waste coupling.
- | SS mesh tray for keeping the dialyzer.
- | Pressure regulating Valve with gauge (Optional).



### Single Station - DWS 1S 100

AMt dt01 t ap -2 nos.

dimension: 33"L x 24.5"W x 33.25"H.



Tap



Mesh



### Double Station - DWS 2S 100

AMt dt01 t ap -4 nos

dimension: 63"L x 24.5"W x 33.25"H

### Three Station - DWS 3S 100

AMt dt01 t ap -6 nos.

dimension: 93"L x 24.5"W x 33.25"H.



## Sluice Sink

designed for use in clinical areas to enable the safe and hygienic disposal of body waste such as contents of vomit bowls, drainage bags, bed pans and urine bottles.

- | Manufactured from 304G stainless steel.
- | The hospital pattern (HTM64) trough has fully radius internal corners for ease of cleaning and hygiene.
- | Conical flushing bowl with continuous flushing rim having whirl effect.
- | Square sink with tap for washing the utensils and hand washing.
- | P / S trap for drainage.
- | Health faucet (Optional).
- | Optional 6 Bed pan & 7 Urine bottle stacker (32"L x 10"W x 28"H).

dimension: 63"L x 24"W x 38"H.



Flush Valve



Health Faucet



## Slope Hopper

- | Manufactured from 304G stainless steel.
  - | Conical flushing bowl with continuous flushing rim having whirl effect.
  - | P / S trap for drainage.
  - | Health faucet (Optional).
  - | Lid (Optional).
  - | Optional 6 Bed pan & 7 Urine bottle stacker (32"L x 10"W x 28"H).
- dimension : 24"L x 24"W x 29.75"H.



Bed Pan and Urine Bottle Stacker



Slope Hopper with Lid and Health Faucet

## Mobile Hygiene Station

- | Manufactured from 304G stainless steel.
- | Disinfection stand with automatic / elbow operated disinfectant dispenser.
- | Soap dispenser adaptable to various sizes of bottles.
- | Hand gloves dispenser.
- | Waste bin.
- | 4 wheels with 2 brakes.
- | Drip tray (Optional).

dimension: 16"L x 12"B x 53"H.



Hand Glove Holder



SS Basket



## Automatic / Elbow operated hand scrub dispenser

- | Manufactured from 304G stainless steel.
- | Can operate the dispenser automatically or through elbow lever.
- | Cartridge free.
- | Adaptable to various sizes of bottles.
- | Easily cleanable parts.
- | Precise pumping mechanism with milliliter accuracy.
- | Flow rate adjustment as per end user requirement.



# 03

SS DOOR FOR  
OPERATION  
THEATRES &  
CLEAN ROOMS



## SS Doors for operation Theatres & Clean Rooms

Hinged doors for operating rooms / clean rooms / IVF labs.

MOC : 1.0mm SS304G Hairline finish (Leaf).  
1.2mm SS304G Satin finish (Frame).

construction : 45mm thick with internal SS reinforcement, insulated with high quality PUF and double insulated vision panels with optional integrated blinds.

Standard Accessories : Door closer, Locks, Handles & Drop seal.

Options : Single Leaf, Double Leaf, Double Unequal Leaf.  
Flexible production in different designs and dimensions.



Unequal Doors with Frame



Equal Doors with Frame



Single Door with Frame

S.No	Model	description	dimension L x H (Clear opening) inches	View Glass	door closer & Handle	drop Seal	radiation protection
1	SLD 100P	Single Leaf Door with Frame	35.75 x 82.75 (31.25)	√	√	√	X
2	DLD UEq 100P	Double Unequal Leaf Doors with Frame	64.75 x 82.75 (60.25)	√	√	√	X
3	DLD Eq 100P	Double Equal Leaf Doors with Frame	64.75 x 82.75 (60.25)	√	√	√	X
4	SLD 100PL	Lead Lined Single Leaf Door with Frame	35.75 x 82.75 (31.25)	√	√	√	√
5	DLD UEq 100PL	Lead Lined Double Unequal Doors with Frame	64.75 x 82.75 (60.25)	√	√	√	√
6	DLD Eq 100PL	Lead Lined Double Equal Doors with Frame	64.75 x 82.75 (60.25)	√	√	√	√

## Radiation Safety Doors

Our designs and manufactures superior quality radiation safety doors in a variety of styles. Our lead lined doors meet all required specifications for radiation and X-ray shielding. Our line of radiation safety doors includes: X-ray room doors / Cath lab / Operating rooms where C arms are used.

MOC : 1.0mm SS304G Hairline finish (Leaf).  
1.2mm SS304G Satin finish (Frame).

construction : The leaf as well as frame will be lined with 1+1mm LEAD sheet of prime quality. The thickness of the leaf will be 45mm having internal SS reinforcement insulated with high-quality PUF and double insulated LEAD impregnated vision panels with optional integrated blinds.

Standard Accessories : Door closer, Handles & Drop seal.

Options : Single Leaf, Double Leaf, Double Unequal Leaf.

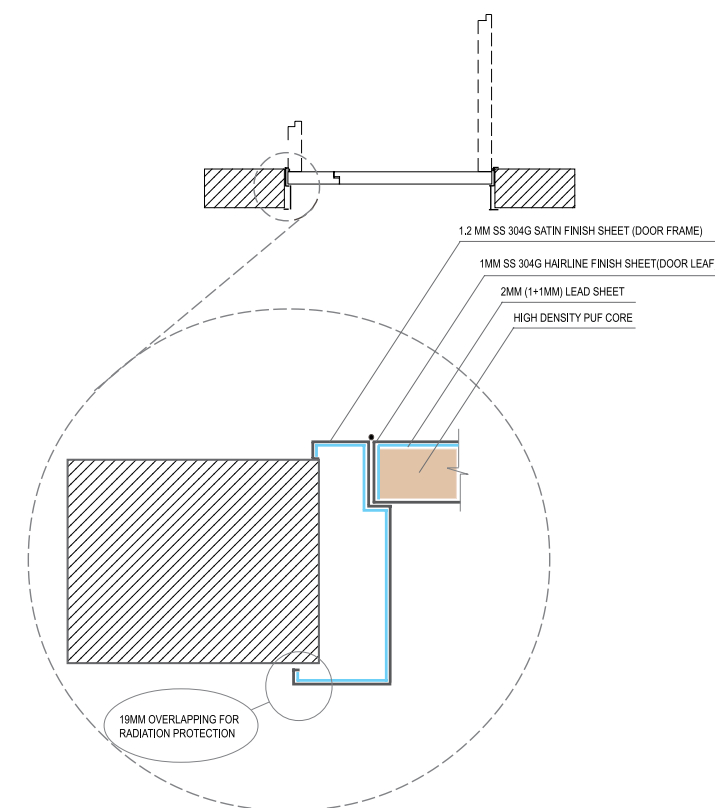



# 04

OPERATING  
ROOM

## Stainless Steel Modular Operation Theatre

Advantages of stainless steel.

Ease of cleaning and disinfection of the room.

High mechanical strength - Panels are resistant to damage, hits and scratches.

Corrosion resistance.

Environment friendly - Stainless steel can be used for a long period of time and after long-term use, it can be recycled.

The system composed of the following elements.

Ultra Clean Ventilation | False Ceiling | Wall | Flooring | Door



### Ultra Clean Ventilation System

- MOC : 1.2mm thick, SS304G / 316G.
- HEPA filter class : EU14 as EN1822.
- Efficiency : 0.3microns standardized at 99.99%.
- terminal Grills : SS304G perforated grills / Double woven polyester Q360 cloth.
- Backlight : Optional.
- type-1 : 1370 x 1370mm (Ophthalmic / ENT).
- type-2 : 2134 x 2134mm (General Surgery).
- type-3 : 2590 x 2134mm (Joint replacement / CVTS / Transplant Surgery).



1) Synthetic Seamless flooring 2) Printed Wall 3) Ultra clean Ventilation 4) SS false ceiling 5) Window 6) SS Wall Panelling 7) Led X-ray Illuminator



### False ceiling

- MOC : 1.0mm thick, SS304G / 316G.
- Standard panel size : 2387 x 550mm.
- Suspender : SS304G telescopic suspender.
- Joints : Silicon filling / Silicon gaskets.



### Wall Panel

- MOC : 1.0mm thick, SS304G / 316G.
- Standard panel size : 2667 x 964mm.
- Backup : High-quality PUF with 0.5mm Al / SS cover plate.
- Joints : Silicon filling / Silicon gaskets.
- fixing method : SS 304G fixing bracket.
- Printed Panels : Optional.



### Flooring

- MOC : Special grade epoxy / Medical grade vinyl.
- ends : Curved skirting.
- thickness : 4mm (Epoxy) / 2mm (Vinyl).
- conductivity : Optional.



### Door

- type : Hermetically sealing sliding / Hinged door.
- MOC : SS 304G / SS 316G.
- thickness : 45mm.
- Leaf filling : High-quality PUF.
- Vision panel : Available.
- radiation protection : Optional.



**Door**  
 type : Hermetically sealing sliding/ Hinged door.  
 MOc: SS 304G / SS 316G.  
 thickness: 45mm.  
 Leaf filling: High-quality PUF.  
 Vision panel: Available.  
 radiation protection: Optional.



**Pass Box**  
 MOc: SS304G / SS316G.  
 door: Mechanical / Electrical interlocking.  
 Buzzer & Indication: Standard.  
 Vision panel: 6 / 5mm glass.  
 UV lamp & Light: Optional.

**Operation Theatre with SS false ceiling**

- 1) Unequal SS Door
- 2) Ultra Clean Ventilation
- 3) SS False Ceiling
- 4) Equal SS Door
- 5) LED Room Light
- 6) Double Window
- 7) Vitrified Tile.
- 8) Synthetic Seamless Flooring



**Window**  
 MOc: SS304G / SS316G.  
 Glass: 6mm toughened.  
 type : Single / Double insulated.  
 Blinds: Optional.



**General Room lights**  
 type : LED.  
 Power: 24W.  
 LUX: 2640.  
 dimension : 300 x 300mm.  
 IP65: Optional.



**UV light**  
 MOc : SS304G / SS316G.  
 Holder: IP65 grade twin holders.  
 UV source: 36W x 2 nos germicidal tube.  
 Life: 16000 working hours.



**Surgeon Control Panel**  
 type : Analogue / Digital.  
 day time clock: 50mm, 7 segment LED (rED).  
 Stop clock: 50mm, 7 segment LED (GrEEN).  
 temperature & Humidity : Dynamic display.



room light control: ON / OFF.  
 Ot light control: ON / OFF.  
 Magnehelic gauge: 0-50mmWc for HEPA filter, -30 0 +30 pascals for room pressure.  
 telephone : Optional.



## Stainless Steel Documentation Station

Stainless Steel Documentation Station console provides a workplace within the Operating room for the end user to manage all of the equipment. The construction of the document station in SS304 will allow the easy maintenance, cleaning and disinfection of the same which is the most desirable feature of an Or surface. Our Documentation Stations greatly improve operating room efficiency and serve as the control point for the Operating Room. Units are ergonomically designed to ensure that the patient will be always in sight of the end user. Each Documentation Station is self-contained with double hull SS construction for routing cables, drawer with lock for safe storage and platform for keeping various equipments.

dimension: 67"L x 31.5"W x 67"H.





# 05

IVF AND  
CLEAN ROOM



- | Wall - Polyurethane paint / SS304G panels which are easily cleanable.
- | False ceiling - SS304G.
- | Doors - Clean room grade doors without joints.
- | Floor - Antistatic Vinyl / Epoxy flooring.
- | Ultra Clean Ventilation - CLASS 100 with Carbon filters to prevent VOC's from atmosphere.



Dynamic Pass Box



Clean room Work Table



Clean room Storage

## IVF Lab

The materials of construction and quality of air within an IVF lab have a critical impact on IVF success. Using SS304G / SS316G for construction of room and CLASS 100 ultra clean ventilation system with carbon filters to prevent VOC's, has been successful in design and installation of several internationally standardized labs in the country.



Sterile Storage



CO<sub>2</sub> Incubator Stand with Storage



Clean room Work Table



Centrifuge Table



Clean room Counter Top with Sink

